

DENTAL BONDING AGENT

**CLEARFIL S<sup>3</sup>BOND**  
[ Clearfil tri-S bond ]



KURARAY MEDICAL INC.  
1621 Sakazu, Kurashiki,  
Shikatsu-cho  
Okayama 710-0801, Japan  
See instructions  
for Use

## Case A

Direct restorations using light-cured composite resin

## Case B

Cavity sealing as a pretreatment for indirect restorations

## Case C

Treatment of exposed root surfaces

## Case D

Intraoral repairs of fractured crowns/bridges made of porcelain or composite resin

## Case E

Surface treatment of prosthetic appliances made of porcelain or composite resin

## Case F

Core build-ups using light- or dual-cured composite resin

S1990EU-02

05/2007

## Case A

### Direct restorations using light-cured composite resin



## Case B

### Cavity sealing as a pretreatment for indirect restorations

B



## Case C

### Treatment of exposed root surfaces

C

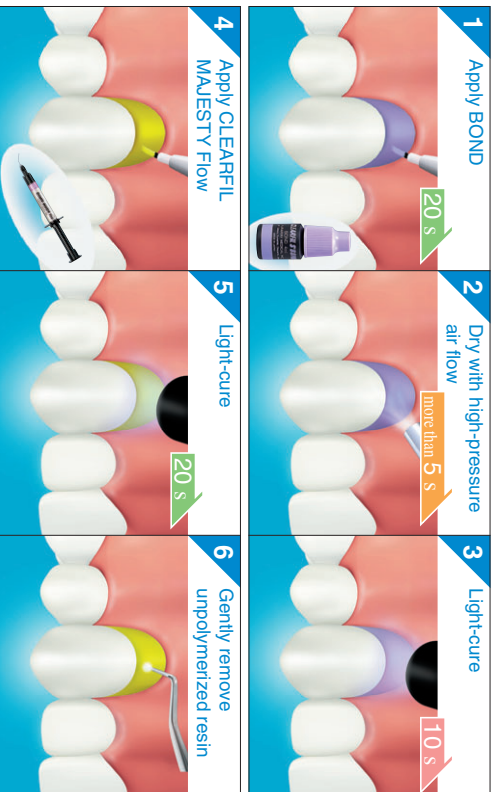

## Case D

### Intraoral repairs of fractured crowns/bridges made of porcelain or composite resin (1/2)



D



## Case D

### Intraoral repairs of fractured crowns/bridges made of porcelain or composite resin (2/2)

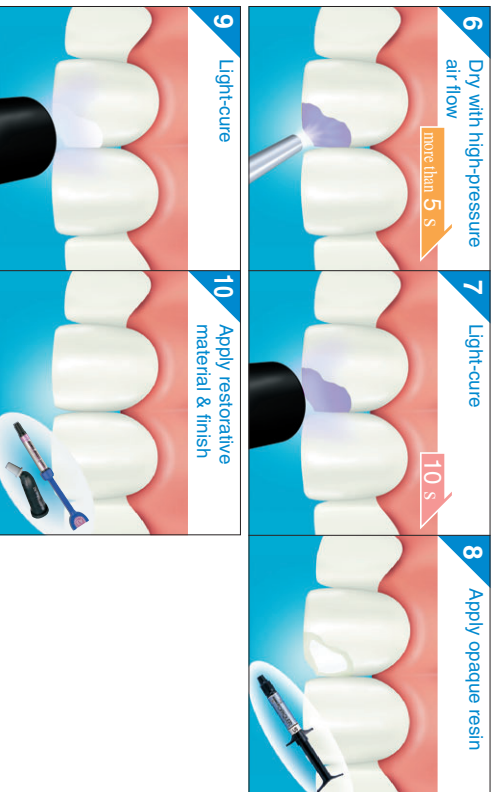

## Case E

Surface treatment of prosthetic appliances made of porcelain or composite resin

<b>1</b> Apply K-ETCHANT GEL 5 s	
<b>2</b> Wash	
<b>3</b> Dry	
<b>4</b> Apply silane treatment 5 s	
<b>5</b> Dry with high-pressure air flow more than 5 s	
<b>6</b> Cementation with PANAVIA	

E

## Case F

### Core build-ups using light- or dual-cured composite resin



F